



COFFEE

# Ceramic Wood Coffee Mill

**USER GUIDE**

MI-008

## **Ceramic Blade**

The ceramic blade will not affect the natural flavor of the coffee beans you grind

## **Granularity Adjustment Screw**

You can choose the thickness / fineness by your own drip method

**Kawasaki-Plastics CO.,LTD.**

401-17 Shimohonai, Sanjo-City, Niigata 955-0021, Japan

TEL.+81256-38-2531 FAX.+81256-38-3666

URL <http://www.kawasaki-plstics.jp/>

## Please read before use

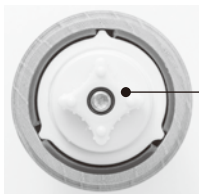

Roughness grain size adjustment screw

- The mill is set to fine grinding when shipped.
- Make adjustments to the powder roughness after trying the initial setting.
- Turning the handle with no coffee beans leaves added can damage the ceramic blade.

# Names

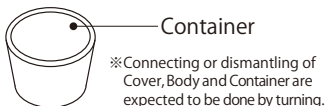
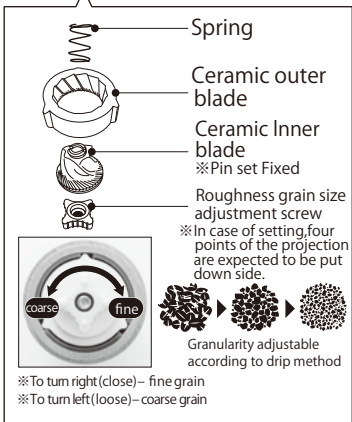
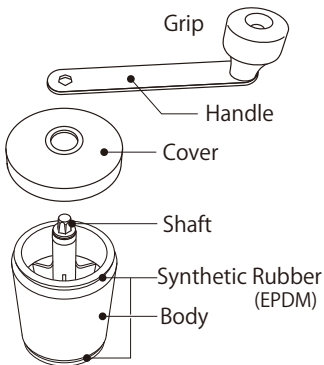

All parts are expected to be set firmly. Otherwise, may cause unsuitable operation or troubles.

# How to use



- 1** Open the cap and put the beans inside the container.

Capacity of Beans /about 18g

※It may very depend on level of roasting.



- 2** Adjust the roughness granularity. (See roughness grain size adjustment method)



- 3** Close the cap and grinding by turning the handle. (Clockwise)

## Roughness grain size adjustment method

(How to turn adjustment screw)

**1**

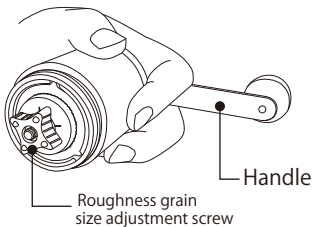

**2**

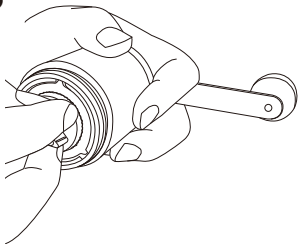

Set the handle, then by controlling it, turn the granularity adjustment screw

## Way of taking pieces apart

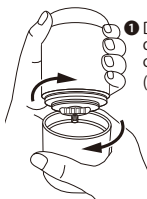

① Dismantling is expected to be done by turning both body and container.

(After being assembled, the body will be put by turning.)

② Turn the coarse particle size adjustment screw and remove the ceramic Inner blade.

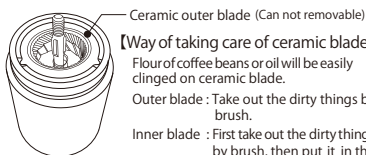
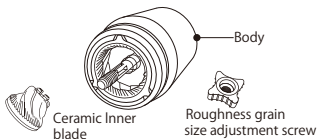

### 【Way of taking care of ceramic blade】

Flour of coffee beans or oil will be easily clinged on ceramic blade.

Outer blade : Take out the dirty things by brush.

Inner blade : First take out the dirty things by brush, then put it in the hot water. After boiling for 30minutes, after dry it well.

## Way of setting up

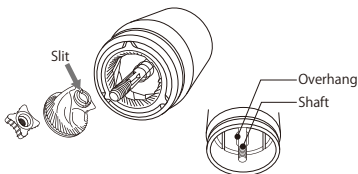

Insert the slit part of the fixed pin to the overhang part of shaft of body. Finally turn the particle size adjustment screw and install.

## Caution

- Do not wash the wood part by water. In case of removing dirty stains, use soft clothes. If the coffee mill will be wet, dry at the place with good ventilation and no direct sun shine.
- For using at some place, put mill at stabilized condition like on the table of dry surface. At grinding in the air, have mill firmly.
- This mill is only for coffee beans, do not use for other purpose. In case grinding raw or wet beans, it may cause some troubles.
- After grinding, to take all coffee flour from mill is expected. Leave coffee flour in the mill for a long time may cause condensed lump by leaked coffee oil.
- Please be careful not to drop it or hit it. It may cause damage. Please do not use it when it is broken.
- Be careful not to grind some foreign materials like small stones. In case of breaking edge, do not use mill.
- If some strange noise is heard with no effective grinding of handle, adjust screw should be loosen. If used continuously, it may cause some troubles.  
( Turn the adjustment screw to the left.)
- If adjust screw will be closed too much to the right, you feel heavy grinding and it may causes troubles.
- In case of break down or assemble mill, read user guide. Forced break down or assemble may cause troubles.
- Do not put mill near the fire. If mill will be exposed by too much strong fire, it may cause melting or deforming of mill.
- Dishwasher-dryers can not be used.
- If one cleans by scourer or strong cleanser mill may be scratched.
- After washed by water, please dry the mill well. (Please do not wash wood parts.)
- In case of preserving, be care not to be touched and played by babies. As well, be care, not to be hit by direct sun shine, is required.
- This products is made by natural wood. If you do not like the special smell of natural wood, put coffee grain for about one day in coffee container, and try to filter coffee flavor into the wood.